

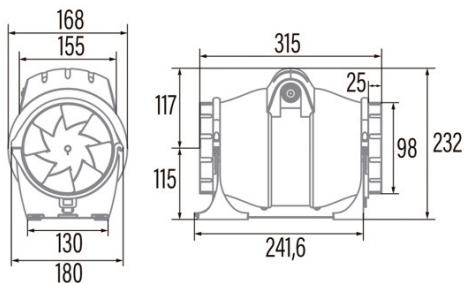

## DUCT IN-LINE 100/270

Cod. **00702000**

EAN **8422248021203**



### GENERAL INFORMATION

EAN/UPC	8422248021203
Subfamily	In Line

### General features

Motor type	AC/INDUCTION
Motor power (W)	18;40
Lighting technology	N/A
Light quantity	N/A
Filter type	N/A
Number of layers	N/A
Control description	N/A
Power levels	2
Timer	-
Hygro timer	-
Electronic filter saturation indicator	-
Dimmable lighting	-

### Installation

Width (mm)	315
Height (mm)	232
Depth (mm)	168
Total minimum height (mm)	2300
Outlet diameter (mm)	98
Maximum pressure (Pa)	150
Anti-return flap included	-
Easy installation system	No

### Power connection

Nominal voltage (V)	230
Nominal frequency (Hz)	50
Nominal input power (W)	18;40
Electric shock protection	Class II
Plug type	No plug

### Accessories

Fixed grill	1910200
Overpressure relief valve	1910300
Switching speed	1142001

### Power and water connection

Nominal voltage (V)	230
Nominal frequency (Hz)	50
Nominal input power (W)	18;40
Electric shock protection	Class II
Plug type	No plug