

## MT-125

Cod. **00720000**

EAN **8422248920520**

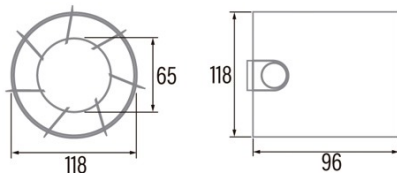

### GENERAL INFORMATION

|           |               |
|-----------|---------------|
| EAN/UPC   | 8422248920520 |
| Subfamily | In Line       |

### General features

|  |                |
|--|----------------|
| Motor type                             | AC/SHADED POLE |
| Motor model                            | SP5820         |
| Motor power (W)                        | 20             |
| Lighting technology                    | N/A            |
| Light quantity                         | N/A            |
| Filter type                            | N/A            |
| Number of layers                       | N/A            |
| Control description                    | N/A            |
| Power levels                           | N/A            |
| Timer                                  | -              |
| Hygro timer                            | -              |
| Electronic filter saturation indicator | -              |
| Dimmable lighting                      | -              |

### Installation

|                           |      |
|---------------------------|------|
| Width (mm)                | 118  |
| Height (mm)               | 118  |
| Depth (mm)                | 96   |
| Total minimum height (mm) | 2300 |
| Outlet diameter (mm)      | 118  |
| Maximum pressure (Pa)     | 48   |
| Anti-return flap included | -    |
| Easy installation system  | No   |

### Power connection

|                           |          |
|---------------------------|----------|
| Nominal voltage (V)       | 220-240  |
| Nominal frequency (Hz)    | 50/60    |
| Nominal input power (W)   | 20       |
| Electric shock protection | Class II |
| Plug type                 | No plug  |

### Accessories

|                           |         |
|---------------------------|---------|
| Fixed grill               | 1920200 |
| Overpressure relief valve | 1920300 |
| Support                   | 1991000 |

### Power and water connection

|                           |          |
|---------------------------|----------|
| Nominal voltage (V)       | 220-240  |
| Nominal frequency (Hz)    | 50/60    |
| Nominal input power (W)   | 20       |
| Electric shock protection | Class II |
| Plug type                 | No plug  |